



Bluetooth Ring Scanner

Wearable Module

Quick Start Guide



BTRS-QS Rev A
4/12

Parts Included in Package

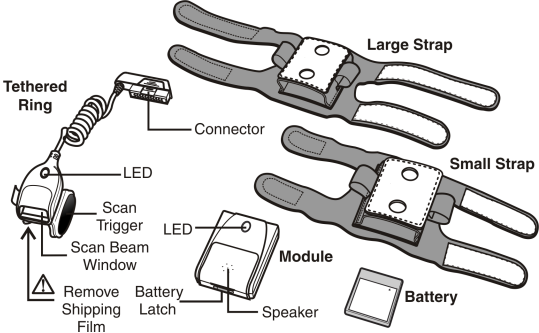

Which Hand Will be Used?

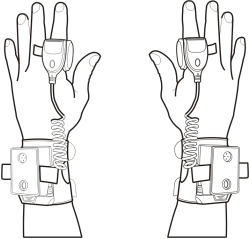

Wear Strap on Wrist (Recommended)

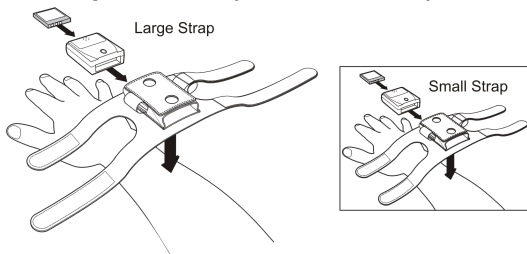

Wear Strap on Hand (Optional)

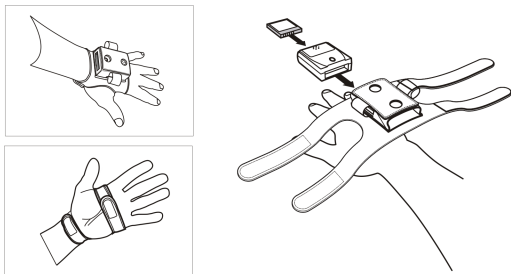

Remove or Install Battery

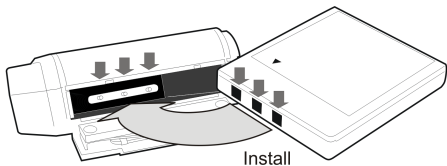
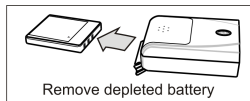
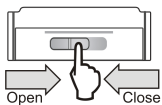

Trigger Rotation

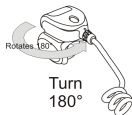

Secure Ring on Finger

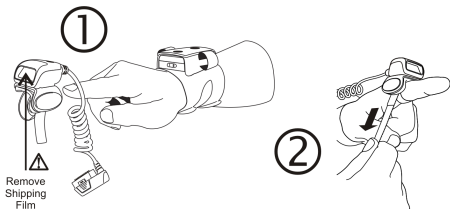

Connect Ring to Module

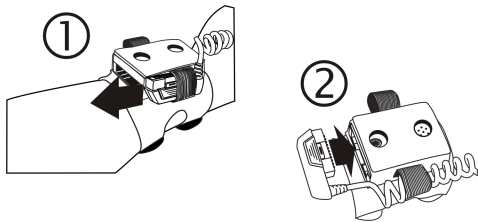

How to Scan a Barcode

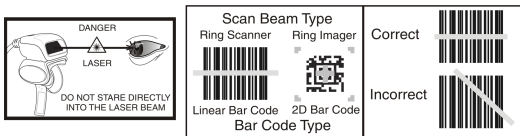

Important

To pair the Bluetooth Ring Scanner module with the host device, look for the linear bar code label on the host device that starts with **LnkB**. Scan the **LnkB** bar code with the ring scanner or ring imager.



Wrist Position When Scanning

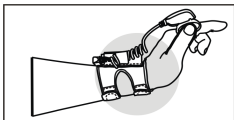

Incorrect Wrist Position

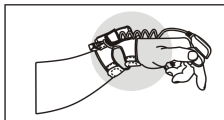

Incorrect Wrist Position

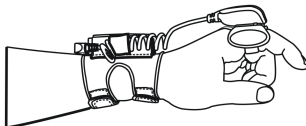

Correct
Wrist
Position

Battery Multi-Charger

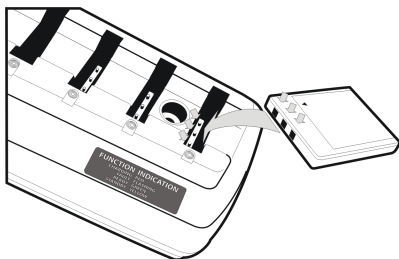

Battery Single Charger

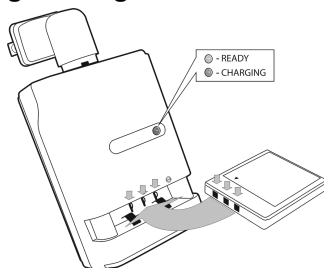

Remove Ring Strap Module

①

Turn 90°

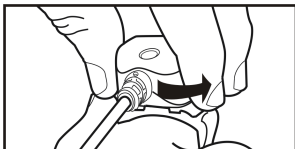

②



③

Press latch
down

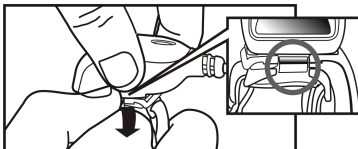

④

Remove
ring strap
module

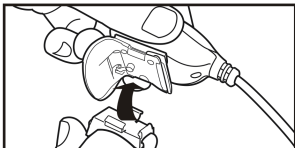

Replace Ring Strap Module

①

Connect ring latch with trigger catch

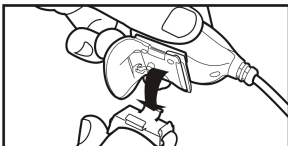

②

Press together until click

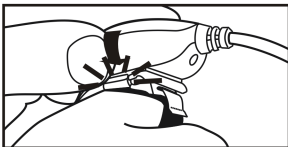

③

Turn 90°



④

Ready to scan

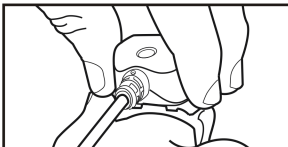

Remove Trigger

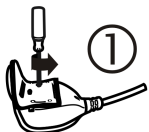

Remove ring strap module. Turn trigger until black screw is visible. Remove the screw.

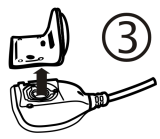

Replace Trigger

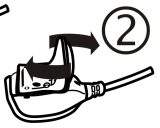

Insert and tighten the screw. Replace ring strap module.

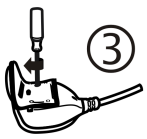

Disclaimer

Honeywell International Inc. (“HII”) reserves the right to make changes in specifications and other information contained in this document without prior notice, and the reader should in all cases consult HII to determine whether any such changes have been made. The information in this publication does not represent a commitment on the part of HII.

HII shall not be liable for technical or editorial errors or omissions contained herein; nor for incidental or consequential damages resulting from the furnishing, performance, or use of this material.

This document contains proprietary information that is protected by copyright. All rights are reserved.

© 2008-2012 Honeywell International Inc. All rights reserved.

Other product names or marks mentioned in this document may be trademarks or registered trademarks of other companies and are the property of their respective owners.

Web Address: www.honeywellaidc.com

Patents

For patent information, please refer to www.honeywellaidc.com/patents.

Technical Assistance

Contact information for technical support, product service, and repair can be found at www.honeywellaidc.com.

Limited Warranty

Refer to www.honeywellaidc.com/warranty_information for your product's warranty information.

User Documentation

To download the Bluetooth Ring Scanner user documentation go to www.honeywellaidc.com.